

Dual Power COOL 12"/30 cm Stand Fan

with DC Motor

User manual

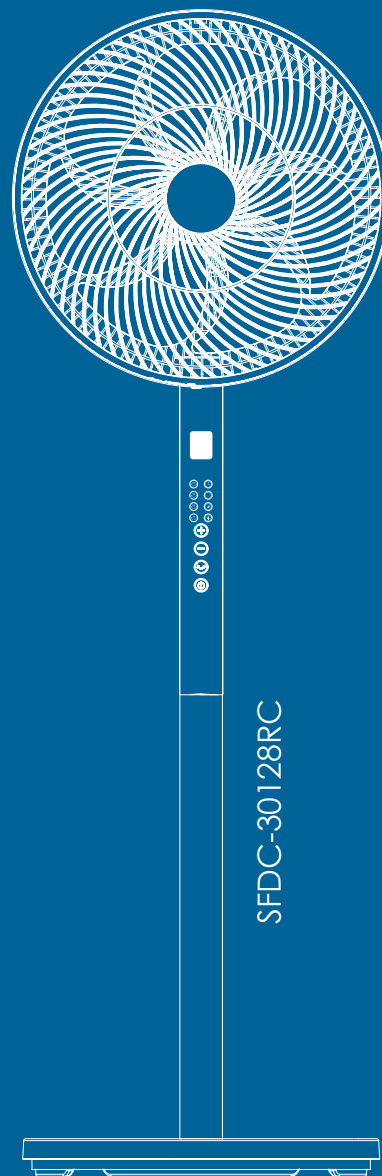

Welcome

With a clear focus on new technologies, innovation and design, NSA^{UK} has played a leading role in the Air Improvement industry for over 20 years.

NSA^{UK} uses the latest technologies to maximise consumer benefits with energy saving DC motors and cordless rechargeability at the forefront.

Boasting 8 Quiet Mark accreditations, NSA^{UK} are the leading brand for build quality & exceptionally quiet performance.



Contents

Thank you for purchasing this 12"/30cm Stand Fan with Energy Efficient DC motor, with lots of new features and new technologies. This elegant, height adjustable tabletop / pedestal fan is ideal for any location ~ home or office. Combining design, quality, performance and safety with significantly reduced running costs (*when compared to traditional 12" / 30cm pedestal fan with AC motor*).

Introduction	4
Box contents	5
Parts description	6
Assembly	8
Operation guide	11
Remote Operation	20
Cleaning & Care	22
Maintenance & Storage	23
Recycling & Disposal	24
Troubleshooting	25
Safety	26
Technical Data	28

Keep safe for future reference.

Introduction

- Cord-Free Portability / Dual Power w. 3-pin adapter or USB PowerPack
- Energy Saving DC Motor
- Ultra-Quiet 7-Blade 12"/30cm Stand Fan
- Remote Control w. 3V battery (CR2032)
- Multi position tilt – Vertical to Horizontal
- Oscillation - 30° / 60° / 90° / 120°
- 32 Speeds
- 3 Modes w. 5 Speed Levels
- 1 to 15 hr Timer (Off)
- 1 to 15 hr Timer (On)
- Carry Handle



Mains Power IN



USB Power IN



What's included

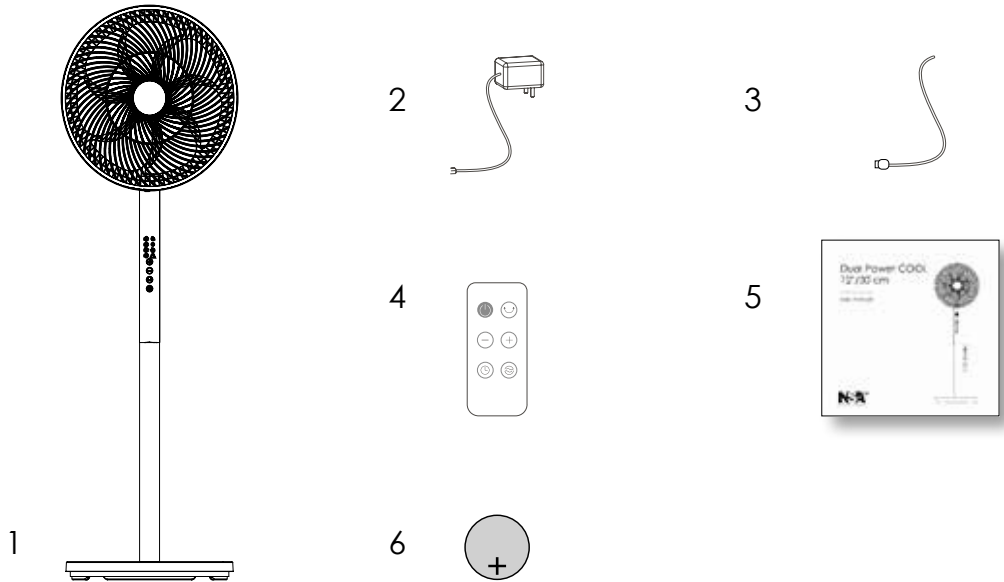

Included in the box you will find:

1. Stand Fan (see page 6 for details)
2. Power Adapter & Cord
3. USB Cable
4. Remote Control
5. User Guide
6. CR2032 Cell Battery for Remote Control

Unpack all items from the box, assemble the fan according to the sequence detailed on pages 8 - 10 and page 21 (Remote Control).

Parts Description

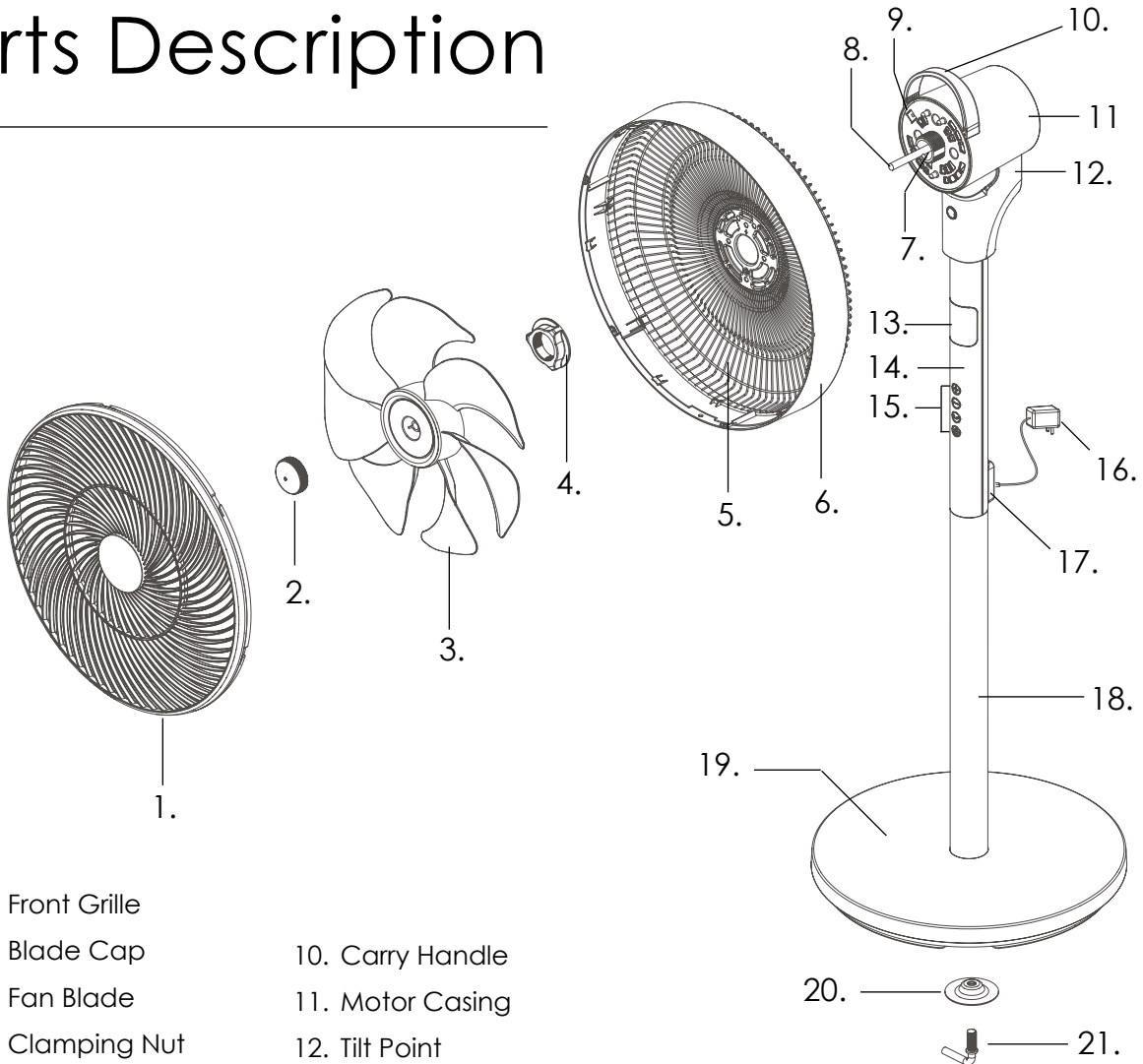

1. Front Grille
2. Blade Cap
3. Fan Blade
4. Clamping Nut
5. Rear Grill
6. Guard Ring
7. Axle Pin
8. Motor Shaft
9. Motor Shell

10. Carry Handle
11. Motor Casing
12. Tilt Point
13. Display Panel
14. Function Icons (OSC, Modes, Timer)
15. Manual Control Buttons
16. Power Adaptor w. 3-pin Plug
17. Power "IN" Toggle Switch (Page 4)

18. Riser Pipe
19. Weighted Fan Base
20. Large Washer
21. "L" Bolt

Controls

Manual controls & Icons

1. Digital Display
2. Oscillation Icons (30° / 60° / 90° / 120°)
3. “+” / “-” Speed / Timer
4. Oscillation control
5. On / Off
6. Timer/Pre-set Timer Icon
7. Eco/AI Mode Icon
8. Sleep Mode Icon
9. Natural Breeze Mode Icon

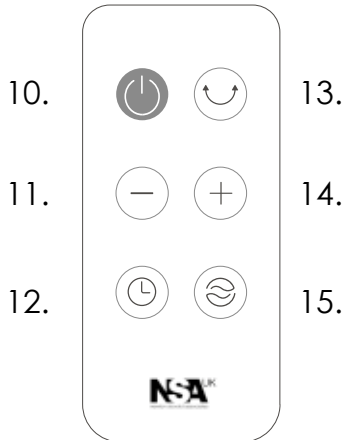
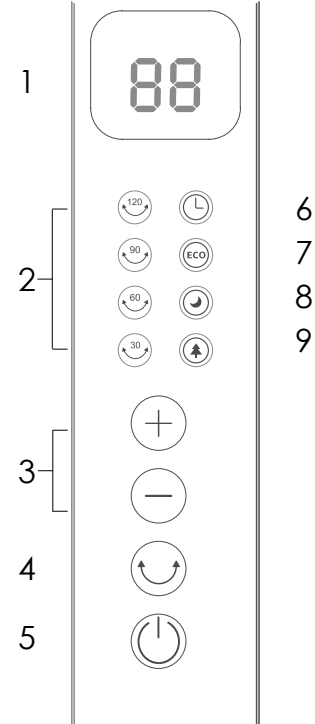

Remote control

10. On / Off
11. Decrease – Speed / Timer
12. Timer / Pre-Set Timer
13. Oscillation
14. Increase – Speed / Timer
15. Mode – Breeze / Sleep / Eco-AI

Assembly

Please assemble correctly according to the following sequence.
Refer to parts description on page 6.

Please keep the original packaging for future storage.

Foot plate assembly:

- Unscrew the L-shaped bolt and metal washer from the riser pipe.
- Insert the vertical pipe into the center hole of the foot plate assembly.
- Then secure in place with L-shaped screw and tighten firmly.

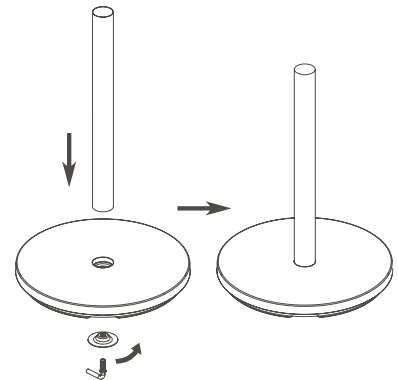

- Loosen the screw at the back of the riser pipe.
- Connect the upper fan body to the riser pipe and refix it with screw.

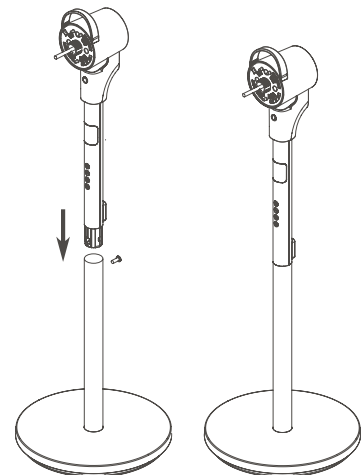

Unpack Motor:

- Before installing the rear grille – remove the blade cap turning clockwise (as indicated).
- Remove the protective plastic tube from the motor shaft. This tube is to prevent motor shaft from rusting during storage – so retain for future use if dismantling your fan for winter storage or discard.
- Remove the grille clamping nut, turning anti-clockwise.

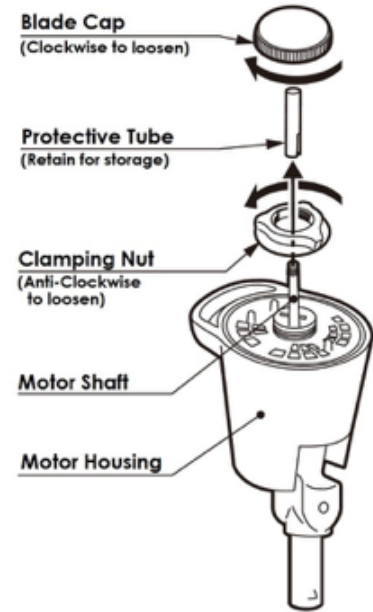

Assemble Rear Grille:

- Align the rear grille with the two lugs at the top of the motor housing (close to carry handle) and the single lug at the bottom.
- Secure the rear grille firmly in place with the clamping nut rotating it clockwise. Do not over-tighten.

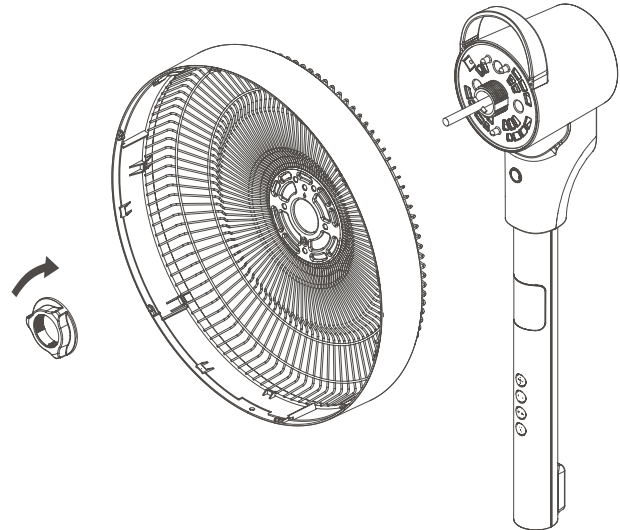

NOTE: The clamping nut should move freely - if there is any resistance, make a half-turn anti-clockwise to realign the thread, then rotate clockwise to secure firmly in place.

Attaching Fan Blade:

- Place fan blade on the motor shaft and align the axle pin with the recess on the reverse side of the fan blade.
- Turn the spinner to the left, so that there is no looseness and the axle pin fits comfortably into the fan blade recess.
- NOTE: Don't forget to remove protective tube before attaching the grilles & fan blade.
- Secure in place with the blade cap turning anti-clockwise (as indicated).

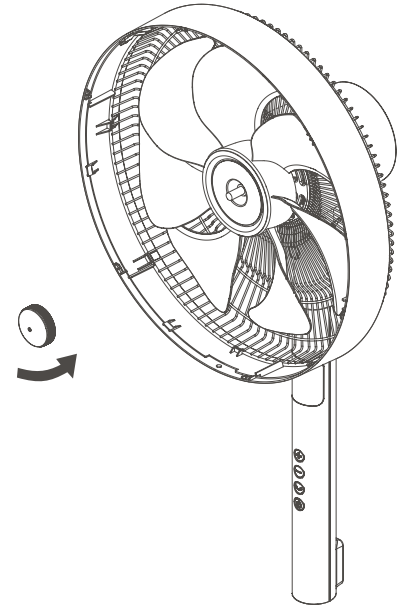

NOTE: The blade cap should move freely - if there is any resistance, make a half-turn clockwise to realign the thread, then rotate anti-clockwise to secure firmly in place.

Attaching the Front Grille:

- Loosen the screw on the guard ring closest to you. If possible, do not remove completely.
- Place the front grille on the guard ring fitting the notches into the recesses along the edges, twist to secure in place as indicated by the arrows on the fan grille.
- Finally, re-tighten the fixing screw.

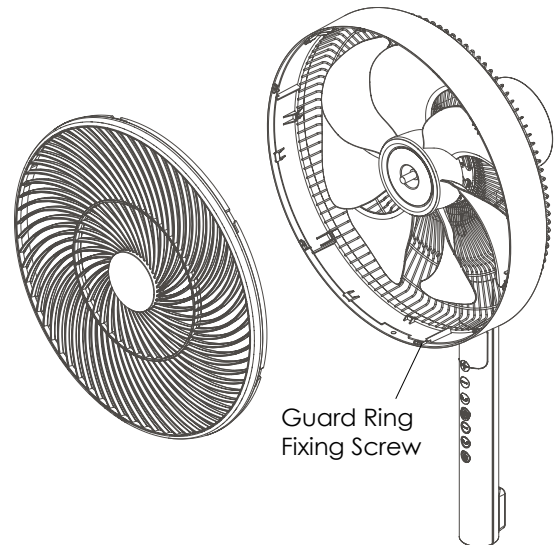

Operation guide

The fan can be operated manually by the control panel on the front of the fan or by the remote control. NB: Certain features (eg: Timer ON or Timer OFF, Mode functions) can only be operated via the remote control supplied with the product.

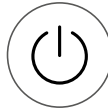

On/Off

Once the unit is connected to the power supply, press the “On/Off” button using the manual control panel or the ⏻ key on the remote control to turn on the fan. The fan will beep to indicate the fan is ready and it will initially start at Speed 12. Subsequent re-starts will remember the previous setting, until turned off and unplugged from the power supply.

To switch off the unit, press the ⏻ button on the manual controls or on the remote control to stop the fan from running.

The display lights will turn off automatically after c. 45secs.

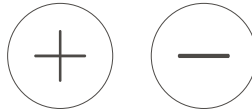

Speed/Airflow

When the fan is first plugged into the electrical supply, the fan speed will be set at speed 12 and one beep will sound. Subsequent uses will remember the previous setting, unless physically unplugged from the power supply.

To increase the speed/airflow use the “⊕” button on the remote control or the manual buttons on the front of the fan. Speed/airflow level is indicated on the display from speed 1 to speed 32.

To decrease the speed/airflow use the “⊖” on the remote control or manual buttons on the front of the fan until you reach your preferred speed setting.

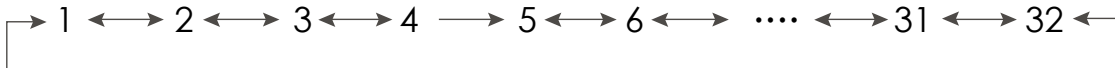

NOTE: Under USB power supply: there are only 1-16 speeds.

The power bank output port needs to be 5V 1.6A, otherwise the power bank may not work normally.

(Please make sure to use a power bank that meets national standards)



Timer/Preset

To set the timer - with the fan powered **ON**, press the TIMER/PRESET button on the remote control and then press “ \oplus ” to increase or “ \ominus ” to decrease timer to set the length of operation or having pressed the TIMER/PRESET on the remote control, use the “ \oplus ” or “ \ominus ” buttons on the manual controls.

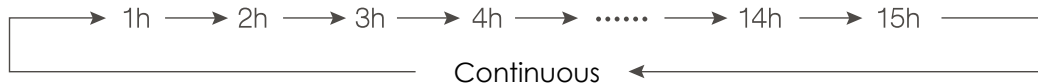

The digital display on the front of the fan will flash during the selection process. When no button is pressed for 3 secs the selection will be set.

The fan will operate normally and automatically turn off at the selected time.

Use in conjunction with the oscillation + fan modes – see page 15 - 18.

The display lights will turn off automatically after c. 45secs.

TIP: Our suggestion is to always use the timer function - even for 1 or 2 hours - that way, you have peace of mind if you leave the room or your house - the fan will automatically turn off when the set time is reached.



Timer/Preset (Delayed Start)

To use PRESET timer for delayed start – the unit must be OFF.

Press the TIMER/PRESET button on the remote control and then press “ \oplus ” to increase or “ \ominus ” to decrease timer to set the length of delayed start between 1hr and 15hrs – this will be displayed at the top of the main panel. It is possible to use the “ \oplus ” or “ \ominus ” buttons on the manual control once you have selected TIMER/PRESET via the remote control.

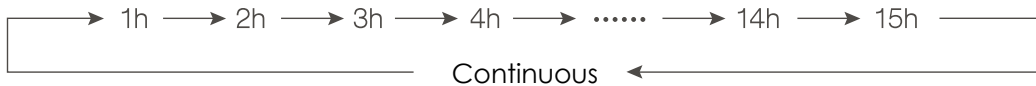

The fan will start when the desired time is reached. It is also possible to set required fan speed, oscillation & mode settings while the fan is off.

The Timer/Preset icon will be lit on the front of the fan to indicate Preset timer is set.

If the Power button is pressed, this will cancel the Delayed Timer and recommence operation at the previous settings.



Oscillation (OSC)

- Press OSC on remote control to select oscillation function – horizontal swing - 30° / 60° / 90° / 120°. Keep pressing until the desired angle of oscillation is reached. The selected angle will be lit on the front of the fan.
- One beep will sound each time the OSC button is pressed and two beeps will sound when de-selecting oscillation function.

NOTE: When changing the oscillation angle, allow time for the motor to adjust to the new setting. It will take a couple of left & right swings to settle into its new rhythm and angle of oscillation.

For the optimum 120° swing the fan head needs to be central to the manual control panel. If the fan head has been manually adjusted to one side or the other, the oscillation swing may be reduced.

Do not manually adjust the fan head position when the fan is operating as this may damage the oscillation function.



Modes

This is the air selection button. Press the mode button once to operate the NATURAL BREEZE mode. Press again to operate the SLEEP mode; Press for a third time to operate ECO/AI mode; press a fourth time to turn-off the wind mode functions and return to normal 32 speeds.



In MODE settings there are five fan speeds within each level (instead of 32) which vary according to the set fan speed.

Under USB power supply: Mode settings only operate within levels 1 – 3 (Speed 16).

These are summarised as follows:

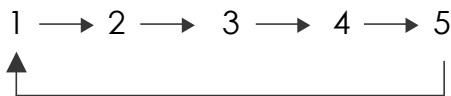

- Level 1 = speed 1 – 6 [USB: speed 1 – 5]
- Level 2 = speed 6 – 12 [USB: speed 5 – 11]
- Level 3 = speed 12 – 19 [USB: speed 11 – 16]
- Level 4 = speed 19 – 26
- Level 5 = speed 26 – 32

BREEZE Mode simulates natural breezes and rhythms and varies according to the fan speed set - press the MODE button once and use the “ \oplus ” or “ \ominus ” buttons on the remote control or manual controls to increase or to decrease to the required setting.

- Use in conjunction with Timer or Preset and OSC functions. The natural breeze will continue to fluctuate according to the speed level set until the timer duration is reached.
- The digital display tree icon will flash during the selection process. When no button is pressed for 3 secs the selection will be set. The digital display will show Preset/Timer and Speed sequentially.

For **SLEEP MODE** ~ press the **MODE button twice** and then use the “ \oplus ” or “ \ominus ” buttons on the remote control or manual controls to make the preferred selection ~ see above for details. Use in conjunction with Timer, Preset or Osc.

- Whatever speed is chosen the fan will operate at the highest level, then it will step down through each level to the lowest in the range and finally to a halt; it will then return to the chosen speed and repeat this circle continuously or until the timer duration is reached.

To select **ECO/AI mode** – press the **MODE button three times** on the remote control. Use in conjunction with PRESET; TIMER and OSC.

Under the **ECO MODE**, the stand fan will adjust the fan speed automatically according to the room temperature.

When the temperature drops or increases by 1°C, the fan will correspondingly decrease or increase by 2 speeds.

As the temperature rises, the speed will no longer increase once it has reached the highest setting. As the temperature drops the speed will reduce, once the lowest speed is reached the fan will continue operating until it is manually turned off or automatically turned off by the timer.

When exiting the ECO/AI mode, the fan reverts to the current real-time working speed. Under USB power supply: ECO/AI mode only has 16 speeds at most.

Tilt Adjustment

- Gently tilt the fan head up or down to the desired angle – there are six tilt positions from vertical to horizontal.
- NB: Only adjust tilt when the fan is turned off. Adjusting tilt when the fan is operating may damage the tilt mechanism.

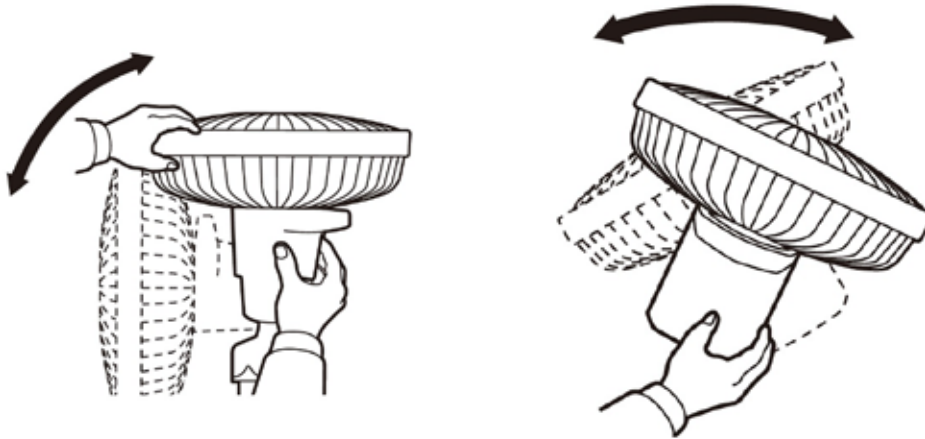

Oscillation Adjustment

- Gently swivel the fan head to the preferred position and angle of swing.
- For the optimum 120° swing the fan head needs to be central to the manual control panel. If the fan head has been manually adjusted to one side or the other, the oscillation swing may be reduced.
- NB: Only adjust the oscillation angle when the fan is turned off. Adjusting the oscillation angle when the fan is moving, may damage the oscillation mechanism.

Remote Operation

- Be sure to direct the remote control toward the receiver on the control panel.
- Use the remote control within 5 metres from the receiver.
- If the remote control is not directed towards the receiver; the effectiveness will be reduced.
- Do not place any obstacle between the receiver and remote control.
- Please treat your remote control with care. Knocking or dropping will reduce its reliability.
- Please store the remote control safely when not in use or in the special recess in the carry handle.

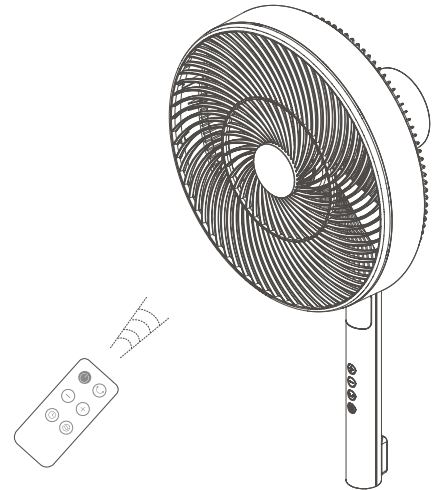

IMPORTANT: This remote control contains a button battery. If swallowed, it could cause severe injury or death in just 2 hours. Seek medical attention immediately.

Replacing the Remote Control Battery (1pc x Lithium 3V CR2032)

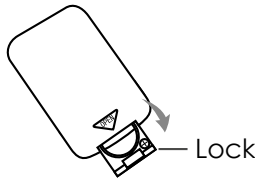

Turn over the remote control. Open the cover of battery compartment ~ squeeze lock towards centre to release

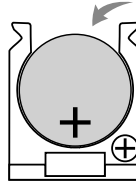

Install the battery into the battery compartment. Take care of the polarity of the battery, which is indicated inside the battery compartment.

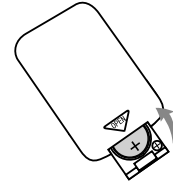

Close the battery cover. Ensure it clicks closed.

NB Please dispose of used batteries responsibly.



WARNING:

Keep Batteries Out of Reach of Children

1. Swallowing may lead to serious injury in as little as 2 hours or death, due to chemical burns and potential perforation of the oesophagus.
2. If you suspect your child has swallowed or inserted a button battery, immediately seek urgent medical assistance.
3. Examine the devices and make sure the battery compartment is correctly secured – eg: that the screw or other mechanical fastener is tightened or locked. Do not use if the compartment is not secure.
4. Dispose of button batteries immediately and safely. Flat/dead batteries can still be dangerous.

Cleaning & Care

- Always turn off the power supply and unplug the appliance from the mains socket or disconnect from the USB device before cleaning.
- Do not use any chemical-based solutions for cleaning fan surfaces.
- Slightly moisten a cloth and then wipe off the surfaces of the fan.
- In order to remove the dust from the protective fan grille use a vacuum cleaner upholstery attachment. To access the fan blade - reverse the assembly instructions on Page
- Ensure fan is completely dry before storage or reconnecting to electrical supply.
- Never immerse the fan or fan motor in water or other liquid.
- If the fan is not used for long periods, protect with a suitable cover after cleaning, then store in a dry place or dismantle and return to retail carton for winter storage.
- Remove battery from remote control before storage.

Maintenance & Storage

Before cleaning or carrying out routine maintenance on your fan please always ensure the product is removed from the power supply.

- Clean the fan body and fan blade to avoid colour change or damage.
- For details on how to remove the front grille for cleaning purposes – reverse the assembly process detailed on Pages 9 & 10.
- Do not let water get into the motor housing during cleaning.
- Use a soft damp cloth to clean the fan blade, grilles, pedestal and base, dry them completely before re-assembly or storage.

Storage ~ after cleaning your fan, please follow the guidelines below to store your product.

- Apply a few drops of lubricant on motor shaft to prevent corrosion.
- Replace the plastic protection tube and reverse the unpacking process detailed on page 9.
- Wherever possible we suggest you keep the original packaging for storing the fan.
- Store the fan in a dry place.

Recycling & Disposal

The packaging of your new fan has a recycle mark on it. Please dispose of it as recycled paper or by using the “Dual System”.



Please recycle



The symbol  on the product or on its packaging indicates that this product may not be treated as general household waste. Instead it should be handed over to the applicable collection point for the recycling of electrical and electronic equipment.

By ensuring this product is disposed of correctly, you will help prevent potential negative consequences for the environment and human health, which could otherwise be caused by inappropriate waste handling of this product. For more detailed information about the recycling of this product, please contact your local council office, your household waste disposal service or the store where you purchased the product.

UK Guarantee

24 months warranty valid only in respect of defects found to be due to faulty workmanship or material. Proof of purchase is required to validate the guarantee. This guarantee is no longer valid if the damage has been caused by a fall, alteration or repair by any unauthorised persons or if the product has been resold. This guarantee in no way affects your statutory rights.

Compliance

For your safety, this appliance complies with the applicable standards and regulations (Low Voltage Directive, Electromagnetic Compatibility, Environmental directives). We reserve the right to make technical changes without prior notice.

Troubleshooting

If any problems occur during use, please check the following:

The fan blade does not run when the power is on:

- Check if the adapter is correctly plugged into the mains socket & the power is on.
- Check if the fan grille is deformed or touching the fan blade.
- Check if you have selected Pre-Set Timer (eg: Countdown Timer / Delayed Start) by mistake. Press On/Off button to override Pre-Set Timer setting.

There is an abnormal sound when starting up:

- Check if the fan blade is inserted correctly onto the motor shaft and the back of the fan blade is completely aligned with the axle pin.
- Check if there are fine burn marks around the fan blade. Check if the fan grilles are deformed or touching the blade. If so, disassemble and reassemble grilles & fan blade – Pages 9-10.
- Any operating queries experienced when using this fan, please email sales@nsauk.com.

Safety

Keep safe for future reference.

1. Check the household voltage to ensure it matches the fan's rated specification before using.
2. Always use this device in accordance with the instructions.
3. Close supervision is necessary when this fan is used near children and pets.
4. Do not allow children to play with the product or product packaging, such as plastic bags.
5. Repairs may only be carried out by a recognised repair centre, incorrect handling and faulty repairs may lead to danger and invalidate warranty.
6. This fan is not intended for use in wet or damp locations.
7. Never position the fan in an area where it may fall into a bath or other water container.
8. Do not use this fan if it has any damaged parts or it has fallen into water. Return the product to a recognised repair centre for examination and repair.
9. Do not insert any object into the grille whilst the fan is operating. It may cause damage to persons or property.
10. Always turn off the power supply before unplugging the product to move, store or clean it.
11. Always use both hands to carry this product. Do not lift by the carry handle alone – please support the fan base.
12. Do not operate the fan near an open flame, cooking or heating appliance or hot surface
13. Always place your fan on a firm, dry, level surface, away from curtains & blinds.
14. This fan is intended for indoor, domestic & light commercial use only and is not to be operated outside.
15. Do not hang anything from the fan grille.
16. Disconnect the unit from the electrical outlet before cleaning.
17. To disconnect from the power supply, grip the plug and pull from the power socket. Never pull by the cord.
18. Arrange the power cord away from an area where it may be tripped over.
19. Never place the power cord under a carpet or rug.
20. Do not direct the fan towards babies or the elderly for extended periods.
21. If the power cord is damaged, it must be replaced by the manufacturer, its service agent or similarly qualified persons in order to avoid a hazard.
22. Do not operate if the fan grille is removed or damaged.
23. This appliance is not intended for use by persons (including children) with reduced physical, sensory or mental capabilities, or lack of experience and knowledge, unless they have been given supervision or instruction concerning use of the appliance by a person responsible for their safety. Children should be supervised to ensure that they do not play with the appliance.

Technical Data

Model No: SFDC-30128RC (12in/30cm DC fan)
EAN No: 5 060301 912117
Rated Power: 20W
Voltage: 220-240V ~ 50Hz
Ref: IM/SFDC30128/2102/GU86AA
Product Dims: 1150 (H) x 370 (W) x 350 (D) mm
Ctn. Dimensions: 380 (H) x 660 (W) x 190 (D) mm
N.W. 5.4kg
G.W. 6.8kg
Class II Product

