

THE ULTIMATE FOLD-AWAY FAN

12in / 30cm Rechargeable, Compact, Folding Pedestal Fan
w. Remote Control, Energy Saving DC motor, Cordless Use,
8hr Timer, 8 speeds & Nightlight

Model: FFRDC-24RC

Instruction Manual

- **Energy Saving** DC Motor
- **Ultra-Quiet** 7-Blade Folding Stand Fan
- **Rechargeable** Built-in 7.4V Lithium Battery
- **Mains** or 5hrs **Cordless**
- Ambient **Light** in Base
- **Remote Control** w. 3V battery (CR2025)
- Oscillation - 90° (base swing)
- 8 Speeds (7 + Turbo)
- 8 hr Timer
- Pre-assembled
- Height **Adjustable** from 53 to 100cm
- **Folds** Down for Easy Storage
- **Vertical** or **Horizontal** Fan Head

Please keep safe for future reference

E: sales@nsauk.com

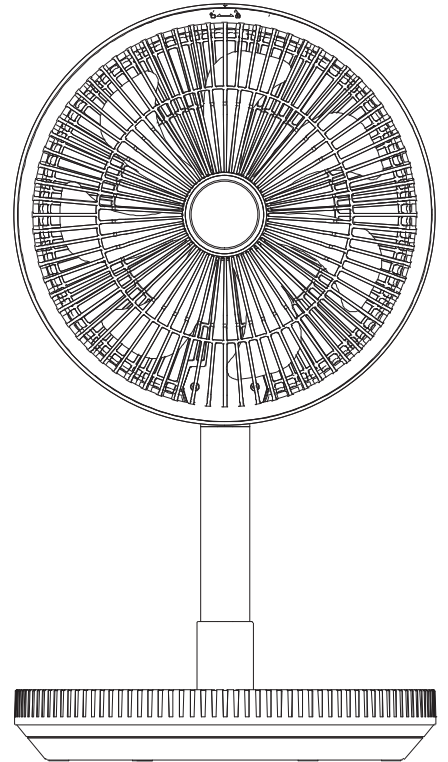

NSA^{UK}
www.nsauk.com





WARNING

Keep Batteries Out of Reach of Children

1. Swallowing may lead to serious injury in as little as 2 hours or death, due to chemical burns and potential perforation of the oesophagus.
2. If you suspect your child has swallowed or inserted a button battery, immediately seek urgent medical assistance.
3. Examine the devices and make sure the battery compartment is securely locked. Do not use if the battery compartment is not secure.
4. Dispose of button batteries immediately and safely. Flat/dead batteries can still be dangerous.
5. Tell others about the risk associated with button batteries and how to keep their children safe.

Replacing the Remote Control Battery (1pc x Lithium 3V CR2025)

- Open the cover of battery compartment ~ squeeze lock towards centre to release.
- Install the 3V cell battery into the battery compartment.
- Take care of the polarity of the battery, which is indicated inside the battery compartment.
- Close the battery cover.

Please dispose of used batteries responsibly.

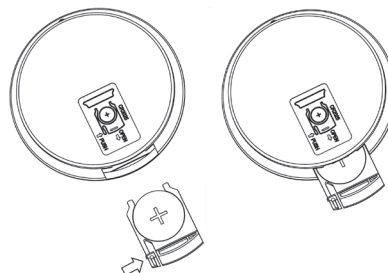

Accessory: Remote Control

- Be sure to direct the remote control toward the receiver on the control panel.
- Use the remote control within 3 metres from the receiver. If the remote control is not directed towards the receiver; the effectiveness will be reduced.
- Do not place any obstacle between the receiver and remote control.
- Please treat your remote control with care. Knocking or dropping it will reduce its reliability.

Please store the remote control in the base of the fan or other safe place, when not in use.

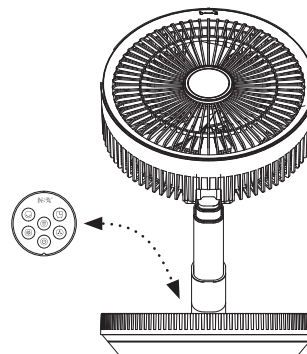

TOP TIPS & QUICK REFERENCE

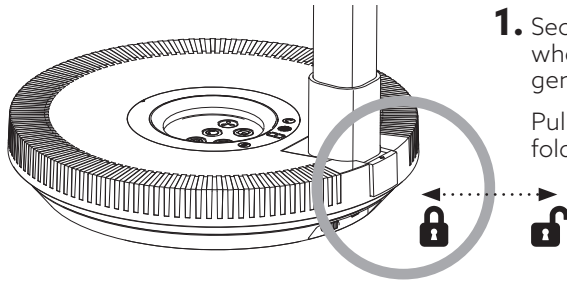

- 1.** Securing clip automatically clicks into upright position when opening fan from folded position. Please be gentle when folding the fan.

Pull clip outwards to release pedestal pole BEFORE folding it across the baseplate to pack away fan.

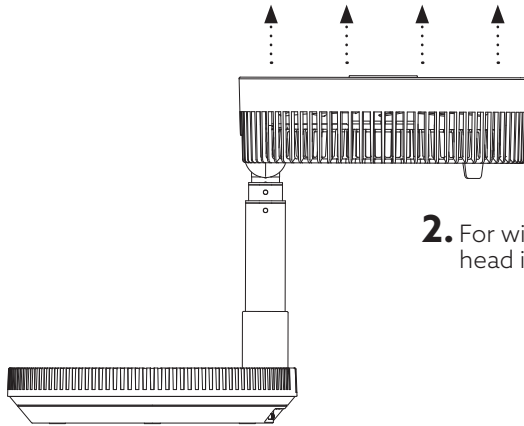

- 2.** For wider air circulation around the room – tilt fan head into horizontal position.

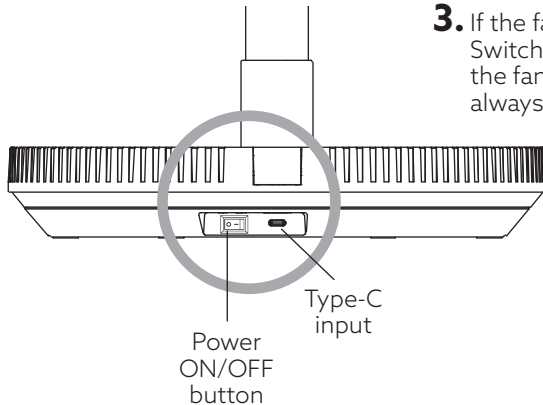

- 3.** If the fan is not working, check the Power Off/On Switch beside the Type-C input port is 'ON'. When the fan is packed flat and especially for winter storage, always ensure the Power Off/On Switch is turned 'off'.



INTRODUCTION

Thank you for purchasing our Rechargeable, Portable Folding Fan. This practical fan is height adjustable from tabletop to pedestal fan and is ideal for any location ~ home or office. Combining design, quality, performance and safety with significantly reduced running costs*.

The equipment bears the UKCA & CE marks indicating its conformity with the provision of UK & EC regulations.

Safety Instructions

Please read this instruction manual before using your 12in / 30cm Portable Folding Fan for the first time and keep safe for future reference.

CAUTION: This fan is designed for domestic use only so please use as described in this manual.

1. Check the household voltage to ensure it matches the fan's rated specification before using.
2. Always use this device in accordance with the instructions.
3. This appliance can be used by children aged from 8 years and above as well as persons with reduced physical, sensory or mental capabilities or lack of experience and knowledge provided they have been given supervision or instruction concerning use of the appliance in a safe way and understand the hazards involved.
4. Children should not play with the appliance.
5. Cleaning and user maintenance should not be carried out by children without supervision.
6. For maintenance or cleaning purposes always disconnect from the mains supply and ensure the fan is also switched off at the fan base before removing the fan grille.
7. Repairs may only be carried out by a recognised repair centre, incorrect handling and faulty repairs may lead to danger and invalidate warranty.
8. Do not allow children to play with the product or product packaging, such as plastic bags.
9. Before using this product, remove the transit packaging (transparent silicone plugs on rear grille) & dispose of these safely to avoid the risk of choking.
10. This fan is not intended for use in wet or damp locations.
11. Never position the fan in an area where it may fall into a bath or other water container.
12. Do not use this fan if it has any damaged parts or it has fallen into water. Return the product to a recognised repair centre for examination and repair.
13. Do not insert any object into the grille whilst the fan is operating. It may cause damage to persons or property.
14. Always turn off the power supply before unplugging the product to move, store or clean it.
15. Always use both hands to carry this product. Do not lift by the fan head alone - please support the fan base.
16. Do not operate the fan near an open flame, cooking or heating appliance or hot surface. Always place your fan on a firm, dry, level surface, away from curtains & blinds.
17. This fan is intended for indoor, domestic & light commercial use only and is not to be operated outside.
18. Do not hang anything from the fan grille.
19. To disconnect from the power supply, grip the plug and pull from the power socket. Never pull by the cord.
20. Arrange the power cord away from an area where it may be tripped over.
21. Never place the power cord under a carpet or rug.
22. Do not direct the fan towards babies or the elderly for extended periods.
23. If the power cord is damaged, it must be replaced by the manufacturer, its service agent or similarly qualified persons in order to avoid a hazard.
24. Do not operate if the fan grille is removed or damaged.
25. For the purposes of recharging the battery, only use the detachable supply unit provided with this appliance.
26. The battery in this device should only be replaced by a qualified electrical technician.
27. Keep the remote control in a safe place when not in use.

BOX CONTENTS

Fan, Adaptor, Remote Control, Cell battery & Manual.

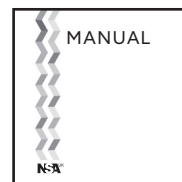
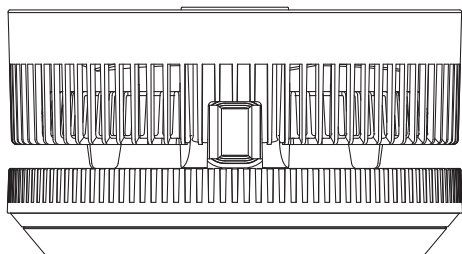

PARTS DESCRIPTION

1. Fan Grille
2. 7-Fin Fan Blade
3. Fan Base w. Manual Control & RC storage
4. Nightlight
5. Oscillating Base
6. Telescopic Pedestal Pole (to 1m tall)
7. Fan Casing

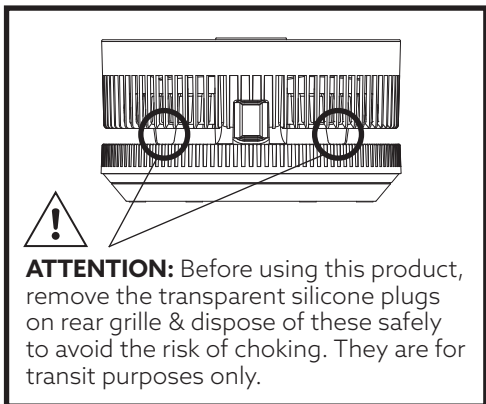
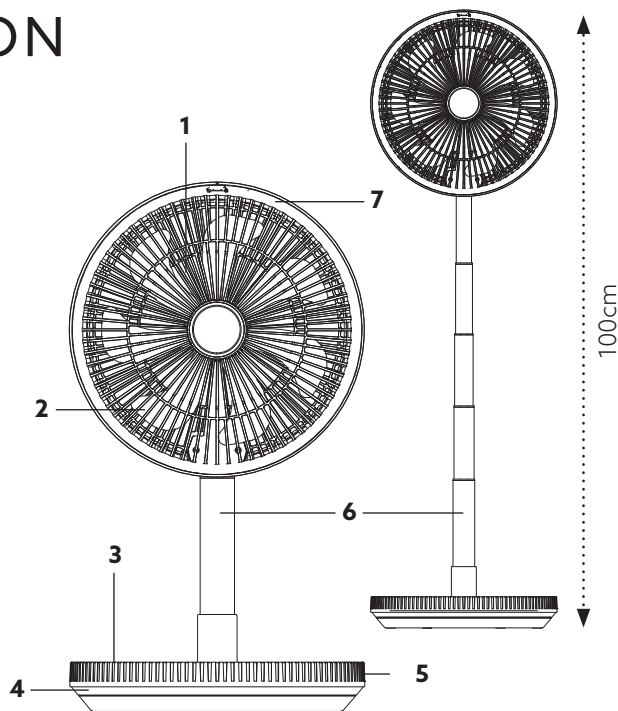

PARTS DESCRIPTION

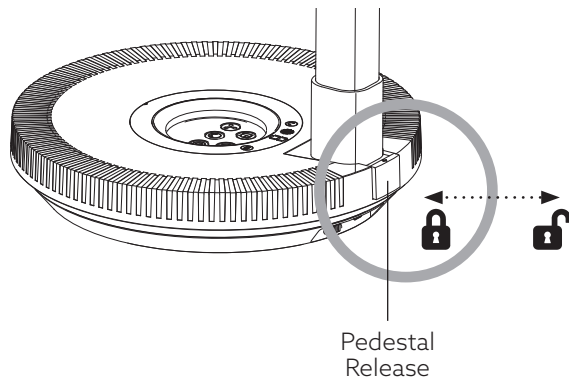
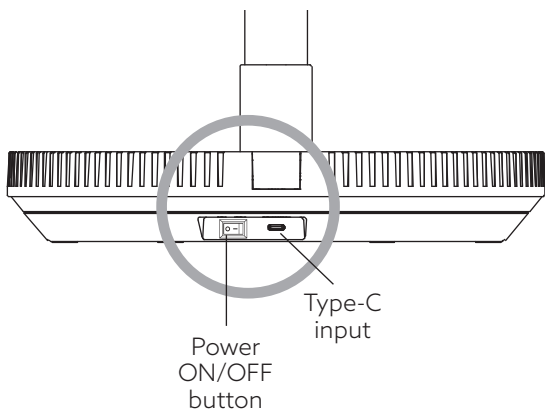

Manual Control Panel / Display

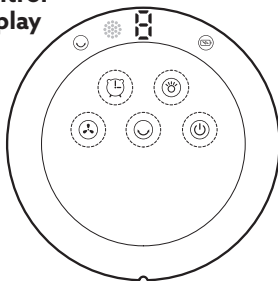

Remote Control

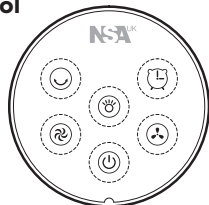

IMPORTANT: This remote control contains a button battery CR2025. If swallowed, it could cause severe injury or death in just 2 hours. Seek medical attention immediately.



Remote Control receiver



Timer / Speed Display



Battery Charge



ON / OFF



8hr Timer



Oscillation



Speeds 1 - 8 (M)



Nightlight





Max. Speed / Turbo (RC only)

OPERATING INSTRUCTIONS

The fan can be operated manually by the control panel on the fan base or by the remote control.



ON/OFF: Once the unit is connected to the power supply, press the "On/Off" button using the manual control panel or the  key on the remote control to turn on the fan. The fan will start at Speed 1.

To switch off the unit, press the  button on the manual controls or on the remote control to stop the fan from running.



TIMER: When the fan is running, the timer can be set for 1 to 8 hours. Press Timer button once to activate timer display and keep pressing until the desired time is selected. The display will flash during the timer selection process. When the set time is reached, the fan will automatically turn off.



OSCILLATION: When the fan is running, one short press on the OSC button on the manual controls or remote control and the fan will swing left & right. To stop this function, press OSC button again.



SPEED: When the fan is running, you can adjust the air volume from Level 1 through to Level 8, one short press per Level. One long press on the manual speed control button for 2 secs to reach Level 8 / 'H' speed straight away. On the remote control there is a separate Turbo / High speed button (see below). The digital display shows the speed set.



NIGHTLIGHT: Press this button for the night light function. Press again to turn off the nightlight. The nightlight alone, during a power cut if no fan function used, could last up to 20hrs on a fully charged battery.



TURBO: When the fan is running, one short press on the turbo button from the remote control, will turn on Level 8 / High Speed.



INFRARED RECEIVER: This is the receiver point for the remote control instructions.



DIGITAL DISPLAY: The default display is Speed setting (1-8). Countdown timer display (1-8hrs) flashes during selection process. Press Timer button once to review the time set.



BATTERY LIGHT: The battery light will glow red when charging and display green when fully charged. The battery light will flash red when the battery is low. It takes 5-6 hrs to fully charge. A full battery will last c.5hrs in low gear or 20hrs nightlight only (powercut).

UNFOLDING & FOLDING UP

1. Place fan on level surface.
2. Hold fan head at opposite side to power switch.
3. Gently lift fan head away from base.
4. Hold base & ease fan into upright position until pedestal clicks into place.
5. Hold fan base securely in one hand and pedestal pole gently but firmly pull upward to extend telescopic pole to preferred height.
6. To pack away fan – repeat in reverse. Hold fan base and then gently ease pedestal down in stages.
7. Once at lowest level, release lock on back of fan BEFORE folding fan head across the base.
8. Do not force the fan in any direction.
9. Do not push down on fan head backwards when in horizontal position.

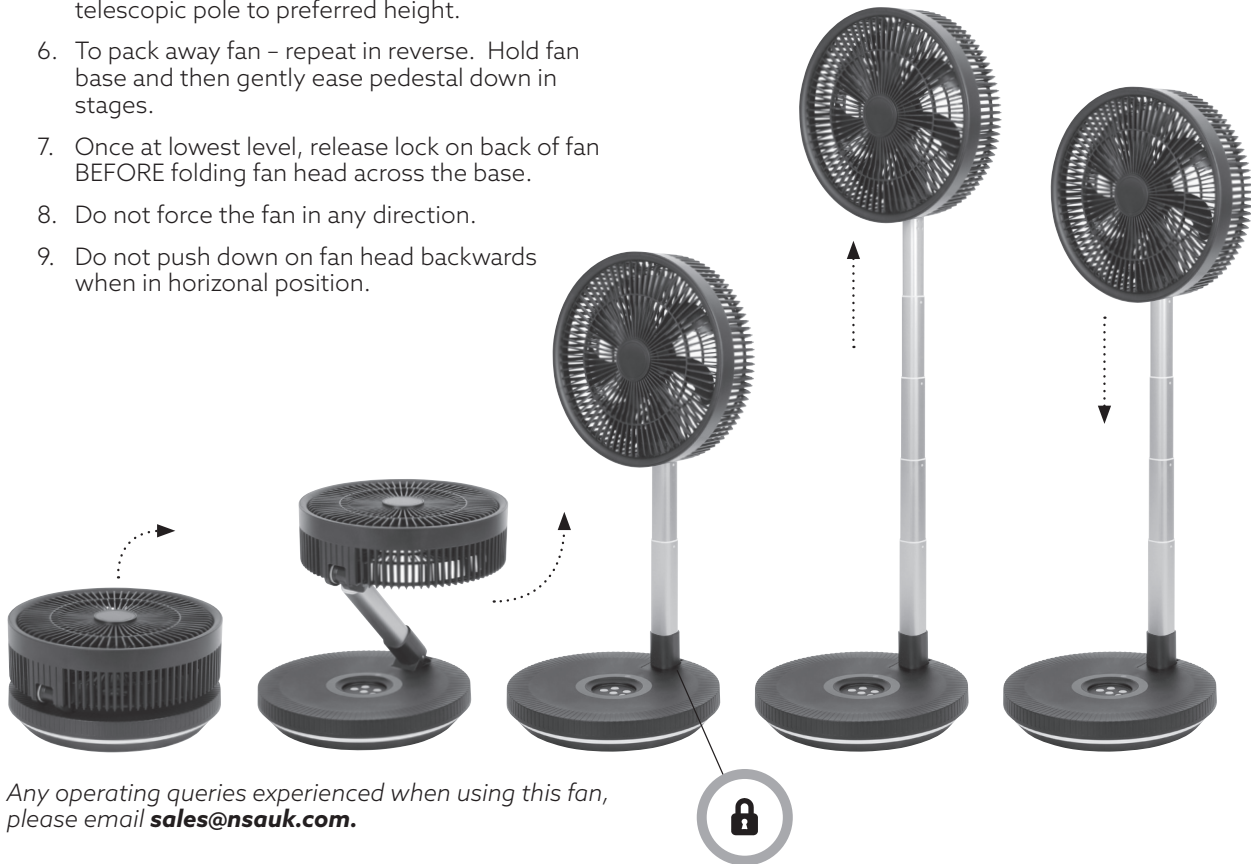

Any operating queries experienced when using this fan, please email sales@nsauk.com.

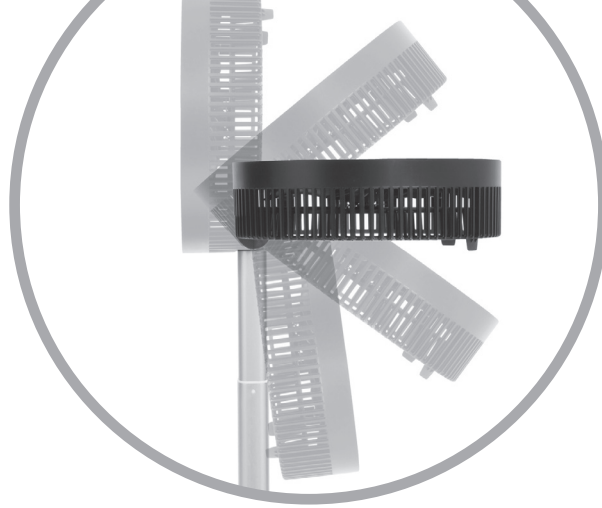

TILTING FAN HEAD

Tilt fan head - hold pole and gently ease fan head backwards to desired angle - from vertical to horizontal or any point in between



MAINTENANCE & STORAGE

Before cleaning or carrying out routine maintenance on your fan please always ensure the product is removed from the power supply and the power button on the fan base is OFF.

- Clean the fan body and fan blade to avoid colour change or damage.
- Never immerse the fan or fan motor in water or other liquid.
- To remove the fan grille for cleaning purposes – see diagram.
- Do not let water get into the motor housing during cleaning.
- Use a soft damp cloth to clean the fan blade, grilles, pedestal and base, dry them completely before re-assembly & reconnecting to electrical supply or before storage.
- Wherever possible we suggest you keep the original packaging for storing the fan. Alternatively, wrap in a bag or old pillowcase.
- Remove battery from remote control before storage.
- Store the fan in a dry place.

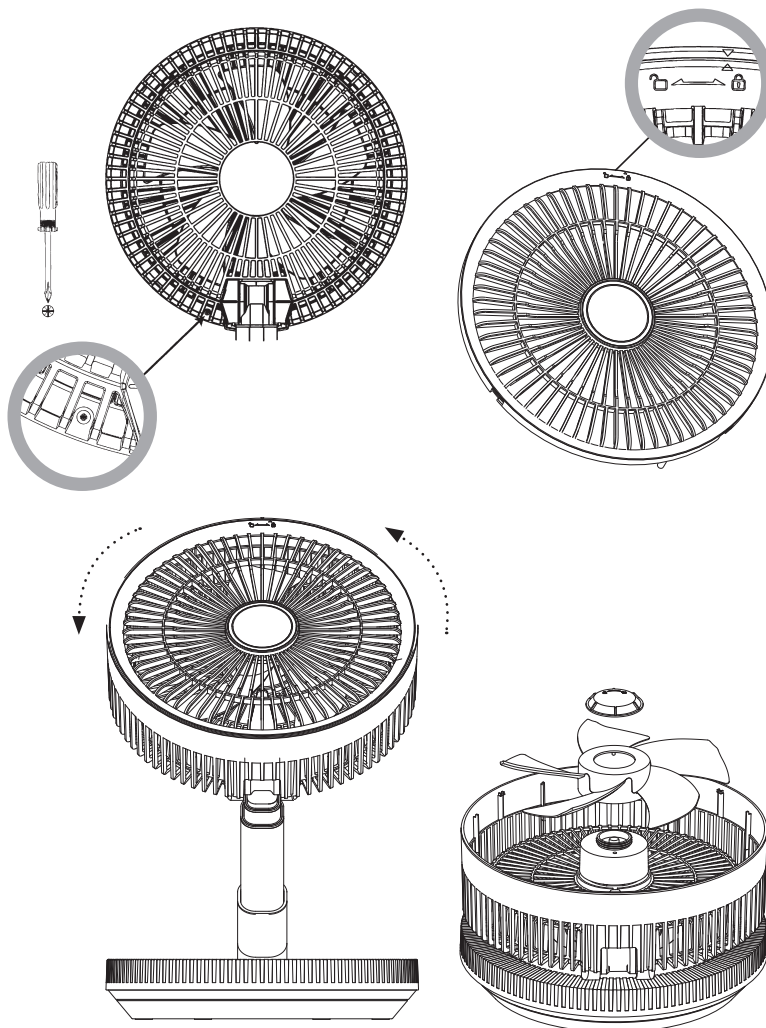

TROUBLESHOOTING

If any problems occur during use, please check the following:

The fan blade does not run when the power is on:

- Check if the overall power switch is on (#3 on Page 3 Top Tips & Quick Reference).
- Check if the power lead is correctly plugged into the mains socket & the mains power is on.
- Check if the fan grille is deformed or touching the fan blade.

There is an abnormal sound when starting up:

- Check the fan blade is reinserted correctly after cleaning and the fan blade is aligned with the axle pin.
- Check if there are fine burn marks around the fan blade.
- Check if the fan grilles are deformed or touching the blade. If so, disassemble and reassemble grilles & fan blade – Page 10.

RECYCLING & DISPOSAL



The packaging of your new fan has a recycle mark on it. If you are not intending to retain the packaging for winter storage, please dispose of it as recycled paper or by using the "Dual System".



The symbol on the product and on its packaging indicates that this product may not be treated as general household waste. Instead, it should be handed over to the applicable collection point for the recycling of electrical and electronic equipment. By ensuring this product is disposed of correctly, you will help prevent potential negative consequences for the environment and human health, which could otherwise be caused by inappropriate waste handling of this product. For more detailed information about the recycling of this product, please contact your local council office, your household waste disposal service or the store where you purchased the product.

COMPLIANCE

This appliance complies with both the low voltage and electromagnetic compatibility directives. Its construction complies with current safety standards. We reserve the right to make technical changes without prior notice.

GUARANTEE

12 months warranty valid only in respect of defects found to be due to faulty workmanship or material. Proof of purchase is required to validate the guarantee. This guarantee is invalidated if the damage has been caused by fall, alteration, or repair by any unauthorised persons or if the product has been resold.

This guarantee in no way affects your statutory rights.

TECHNICAL DATA

Model No:	FFRDC-24RC (12in/30cm DC Folding fan)
Ref:	IM/FFRDC24/BA98LX/2301
Voltage:	220-240V ~ 50Hz
Charging Voltage:	5V === 3A
Working Power:	12W
Light Source:	LED
Prod. Dimensions:	530 - 1000 (H) x 300 (W) x 300 (D) mm
Ctn. Dimensions:	360 (H) x 350 (W) x 205 (D) mm
Weight:	N.W. 2.75kg (incl. rechbl. Lithium battery 175gm) G.W. 3.75kg

